



# PERMAS HEIGHTS

Ⓐ WATERFRONT

**MB** | PERMAS JAYA  
**W**

**Developer :**  
**Blooming Properties Sdn. Bhd.**

---

## PROJECT BRIEF

---

# PROJECT DATA

Project Name	Permas Heights @ Waterfront					
Developer	Blooming Properties Sdn. Bhd. (202401021031 (1566880-P))					
Location	PTD 229077 & PTD 229080, Mukim Plentong, Daerah Johor Bahru, Johor darul Ta'zim					
Type of Development	<ul style="list-style-type: none"> <li>4 blocks of 26-level serviced apartment, Block A - 500 units, Block B - 500 units, Block C - 450 units, Block D - 500 units</li> <li>1 level of recreational facilities</li> <li>8 levels of car park</li> <li>1 Unit of guardhouse</li> </ul>					
Land Area	11.01 acres					
Land Tenure	Freehold					
Unit Details	Tower	Type	Bedrooms	Bathrooms	Built-up Area (sqft)	Total Unit
	A	A	2	2	650	150
		B	3	2	801	150
		C	3	3	948	200
	B	A	2	2	650	150
		B	3	2	801	150
		C	3	3	948	200
	C	A	2	2	650	150
		B	3	2	801	150
		C	3	3	948	150
	D	A	2	2	650	150
		B	3	2	801	150
		C	3	3	948	200
	<b>Total</b>					<b>1950</b>

Key Project Features	<ul style="list-style-type: none"> <li>• <b>Connectivity:</b> Strategically located with easy access to CIQ Complex and JB Sentral.</li> <li>• <b>Convenience:</b> Easy access to shopping malls, hospitals and schools.</li> <li>• <b>Wide Array of Facilities:</b> Catered to all age groups</li> </ul>
Facilities	<ol style="list-style-type: none"> <li>1. Swimming Pool</li> <li>2. Kids Pool</li> <li>3. Playground</li> <li>4. Games Room</li> <li>5. Management Office</li> <li>6. Prayer Room</li> <li>7. Child Care</li> <li>8. Kid's Jungle</li> <li>9. Yoga Room</li> <li>10. GYM Room</li> <li>11. Multipurpose Hall</li> <li>12. Reading Room</li> </ol>



CONFIDENTIAL. FOR INTERNAL REFERENCE ONLY . DO NOT DISTRIBUTE  
LAST UPDATED 28 OCT 2024



# LOCATION

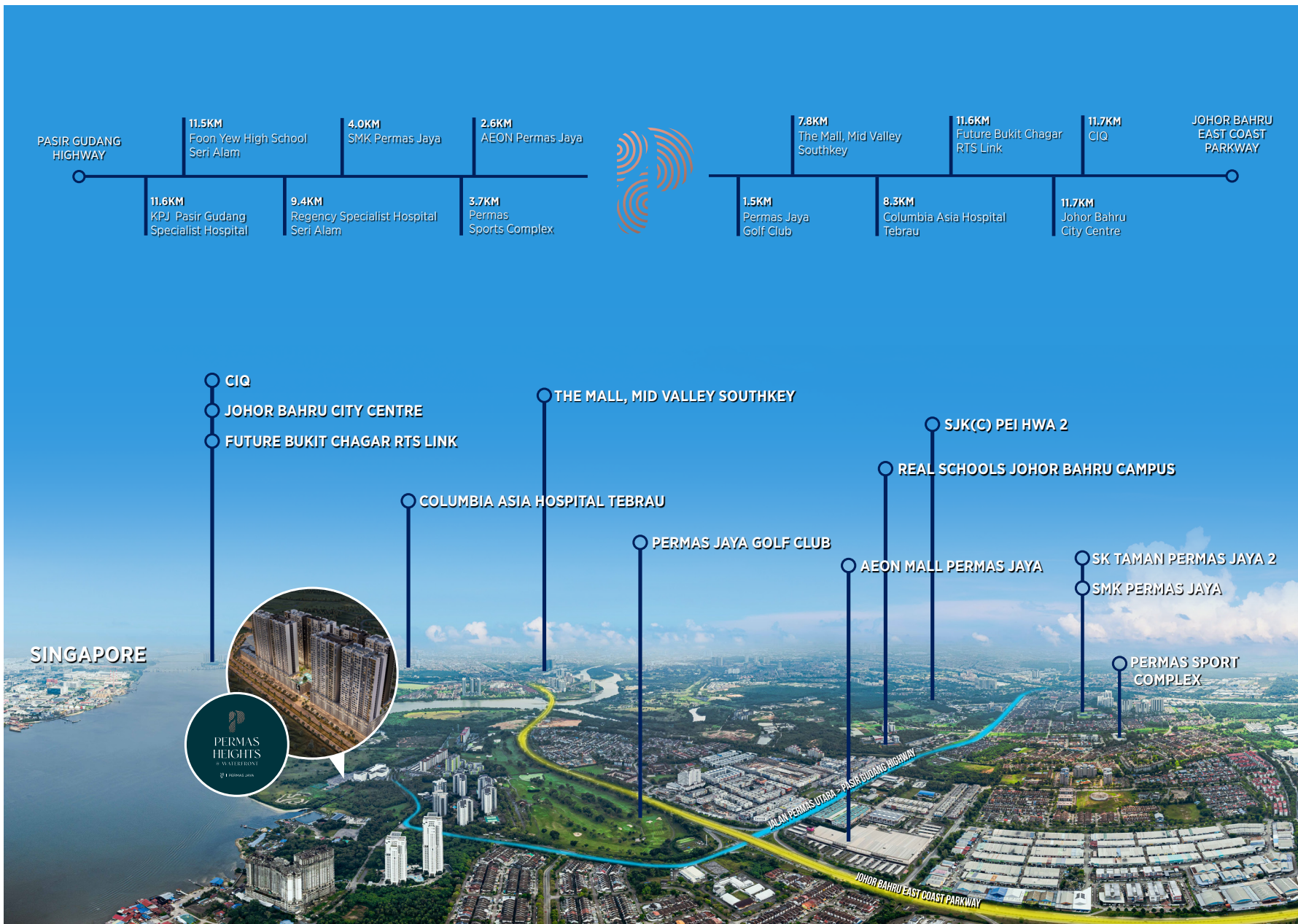

CONFIDENTIAL. FOR INTERNAL REFERENCE ONLY . DO NOT DISTRIBUTE  
LAST UPDATED 28 OCT 2024

# NEARBY AMENITIES

SHOPPING		KM
1	AEON Permas Jaya	2.6
2	Giant (Plentong)	6.5
3	Lotus's (Plentong)	6.7
4	The Mall, Mid Valley Southkey	7.8
5	Mydin (Taman Rinting)	8.5
6	Lotus's (Seri Alam)	8.9
7	Today's Market	9.3
8	NSK Trade City Pandan	10.9
9	AEON (Taman Desa Tebrau)	12
10	IKEA (Taman Desa Tebrau)	12.7
11	TOPPEN (Taman Desa Tebrau)	13.1

RECREATION		KM
1	Permas Jaya Golf Club	1.5
2	Permas Sports Complex	3.7
3	Tiara Sports World	6.4
4	Seri Alam Bike Park	9.3
5	Ponderosa Golf & Country Resort	11.5
6	Bukit Layang-layang	12.7

EDUCATION		KM
1	REAL Private and International Schools, JB Campus	3.7
2	SMK Permas Jaya	4.0
3	SJK(C) Pei Hwa 2	5.7
4	Paragon Private & International Schools	6.5
3	The Japanese School of Johor	10
4	UiTM Pasir Gudang	11.1
5	Invictus International School	11.3
6	Foon Yew High School Seri Alam	11.5
7	Austin Heights Private & International Schools	13.2
8	Sunway College, Johor Bahru	14
9	Universiti KL MITEC	14.4

HEALTHCARE		KM
1	Columbia Asia Hospital Tebrau	8.3
2	Regency Specialist Hospital	9.4
3	KPJ Pasir Gudang Specialist Hospital	11.6
4	Sultan Ismail Hospital	12.7
5	Penawar Hospital Pasir Gudang	13.5

# SITE PLAN

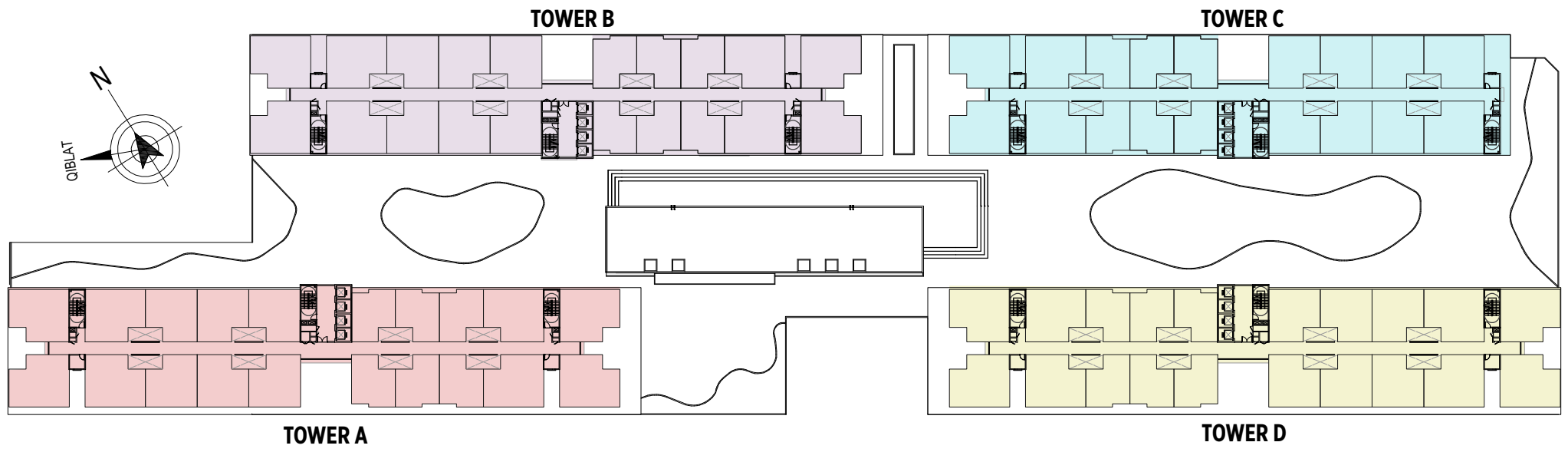

# TYPICAL FLOOR PLAN

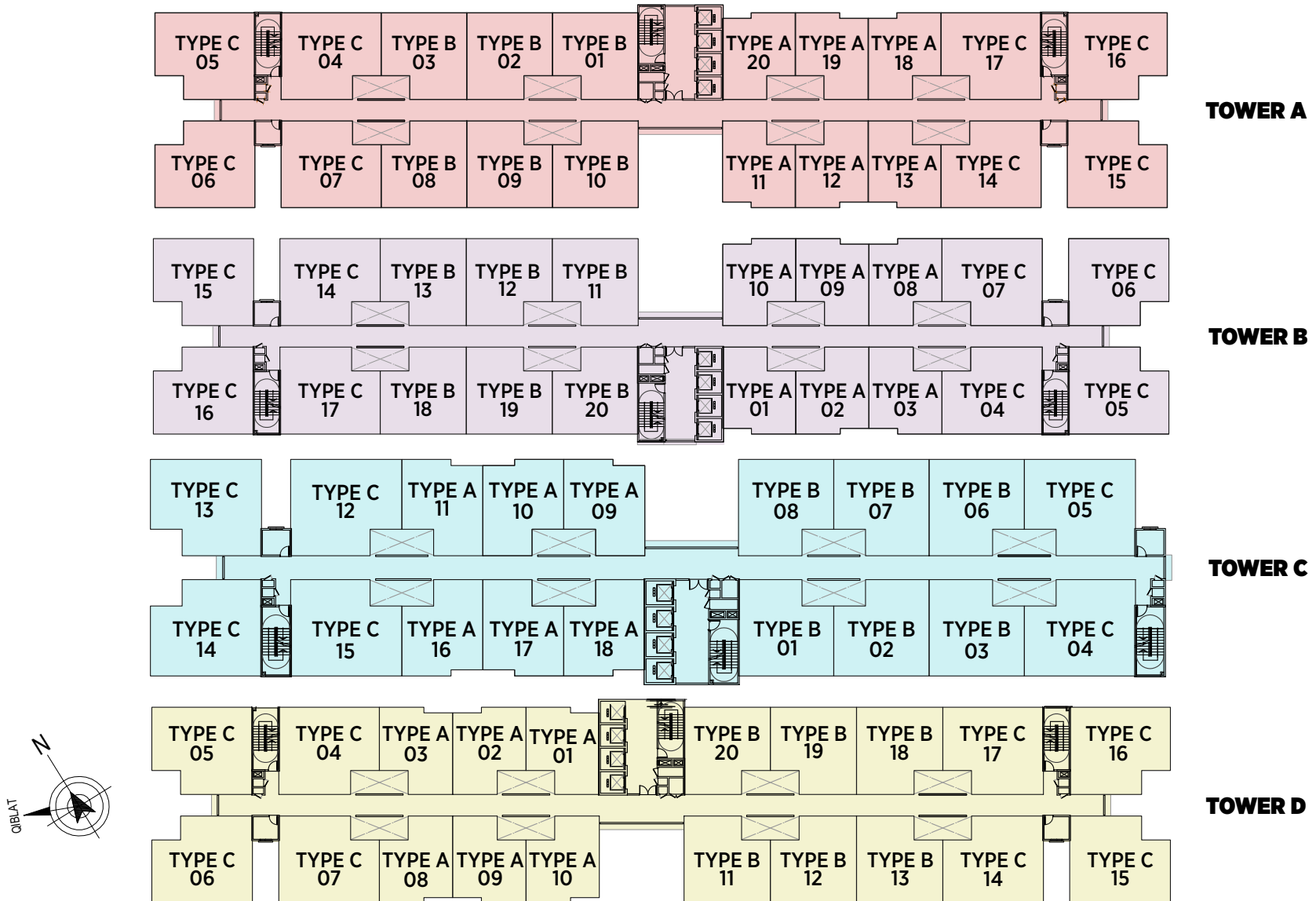

# TYPICAL FLOOR PLAN

Tower A

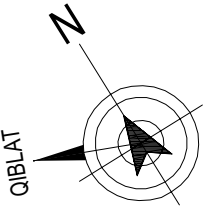
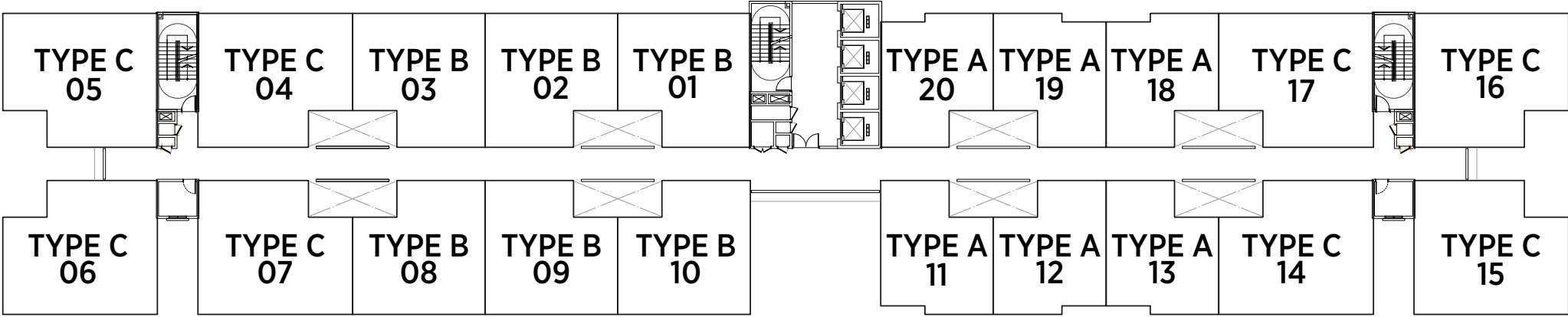

# TYPICAL FLOOR PLAN

## Tower B

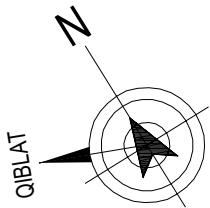
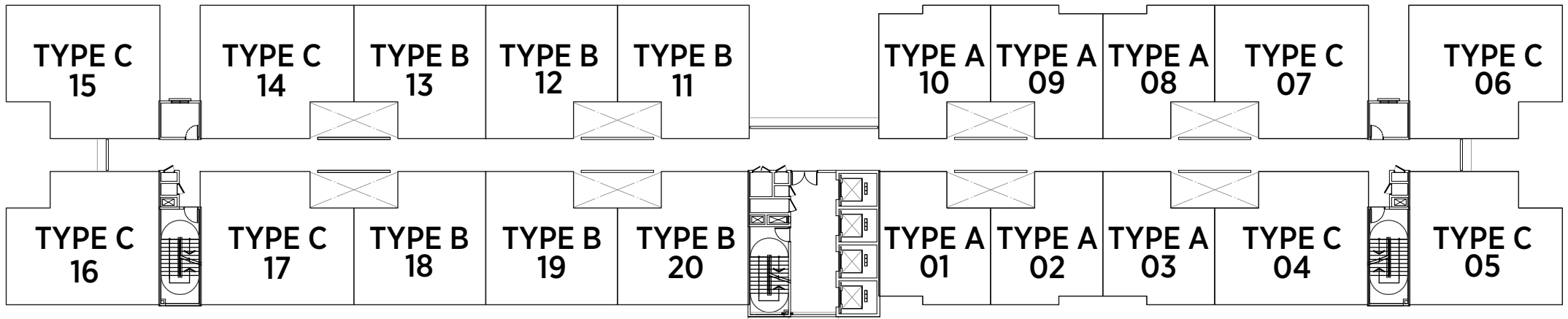

# TYPICAL FLOOR PLAN

## Tower C

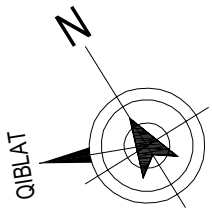
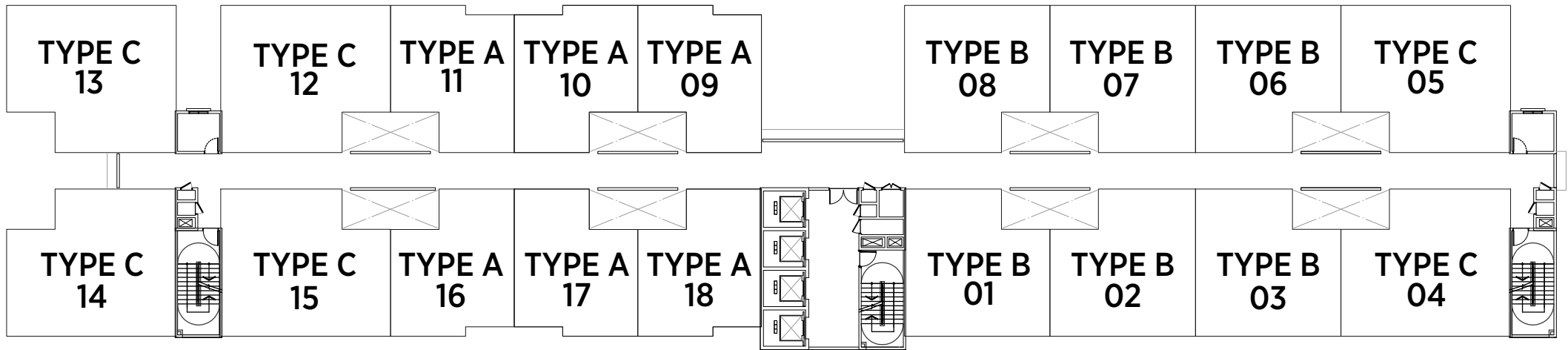

# TYPICAL FLOOR PLAN

Tower D

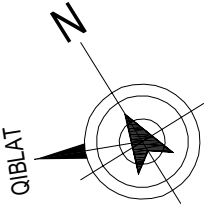
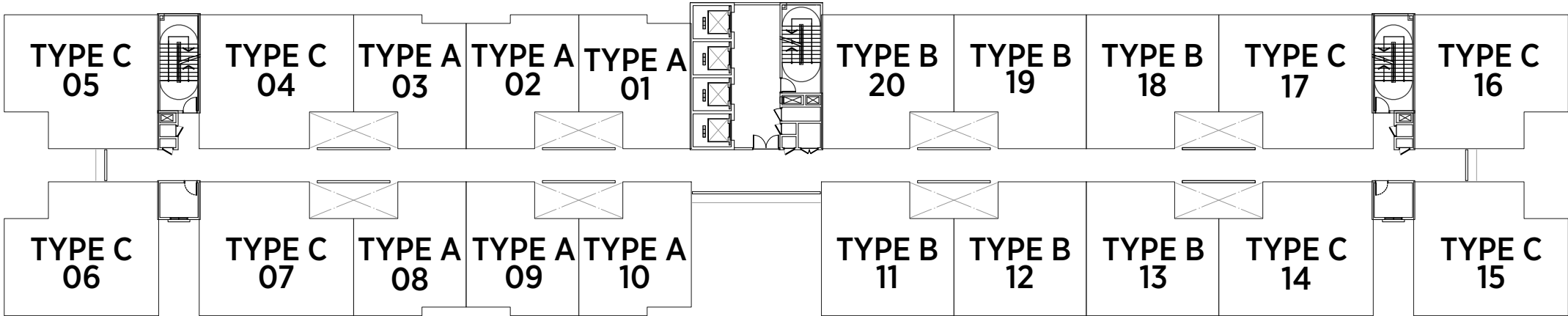

# TYPICAL UNIT PLAN

## TYPE A

- 2 Bedrooms & 2 Bathrooms
- 650 sqft
- 600 units

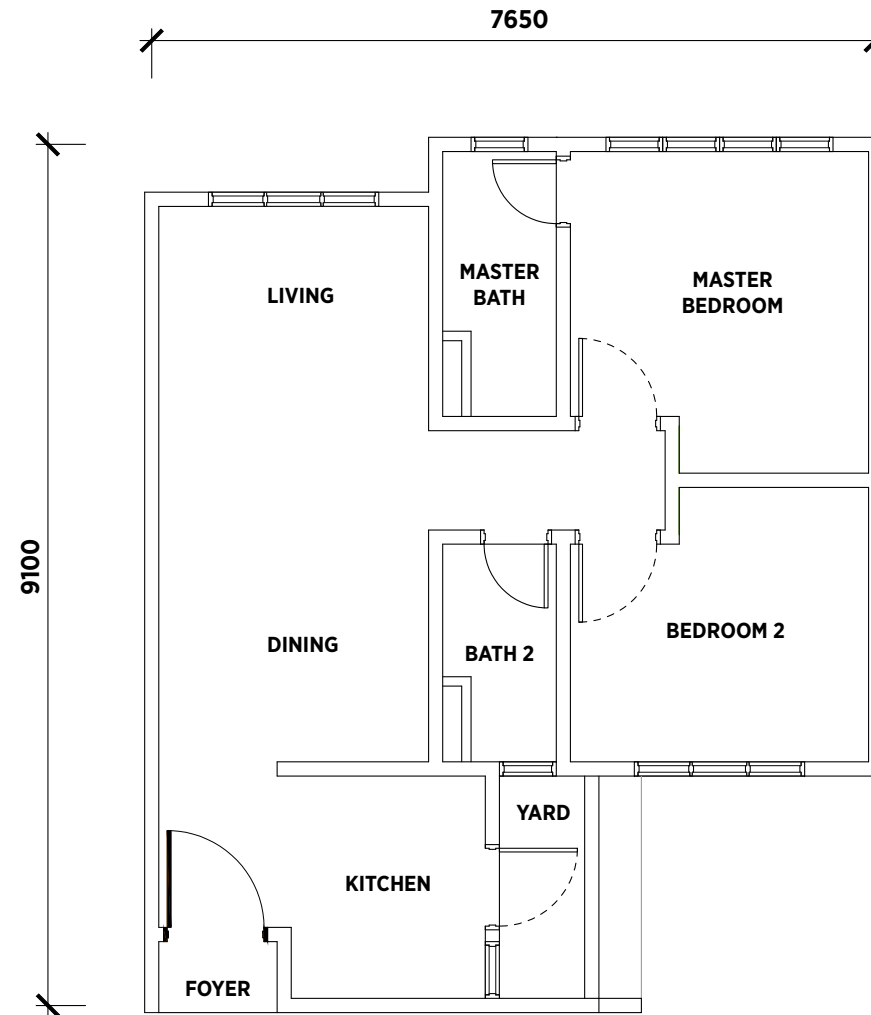

# FURNITURE PACKAGE

## TYPE A

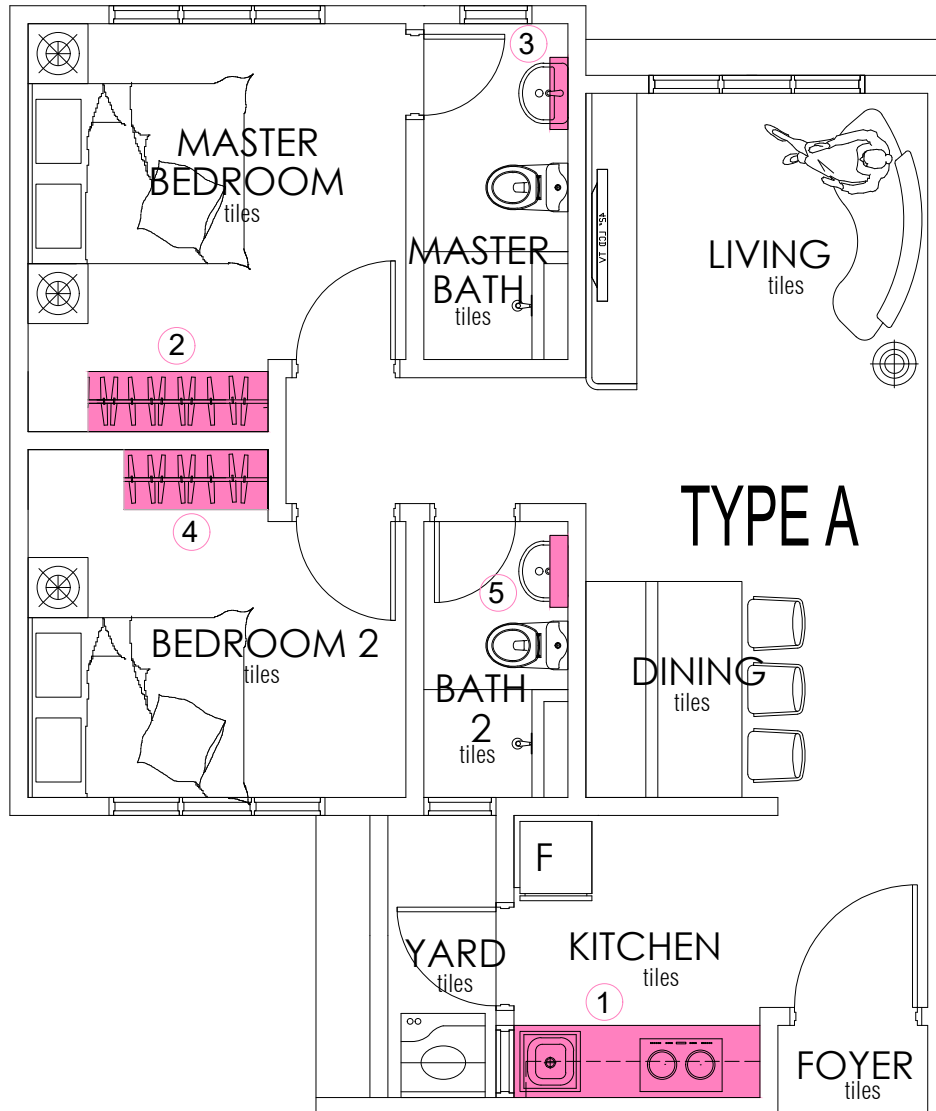

	ITEM	QUANTITY
1.	<u>Kitchen :</u> Kitchen cabinet (hood and hob)	1 Set
2.	<u>Master Bedroom:</u> Wardrobe 1.5 meter length	1 Set
3.	<u>Master Bath:</u> Vanity wall mirror cabinet	1 Set
4.	<u>Bedroom 2:</u> Wardrobe 1.2 meter length	1 Set
5.	<u>Bath 2:</u> Vanity wall mirror cabinet	1 Set

KITCHEN CABINET  
TYPE : A



MASTER BEDROOM  
TYPE : A



BEDROOM 2  
TYPE : A



MASTER BATH & BATH 2

TYPE : A

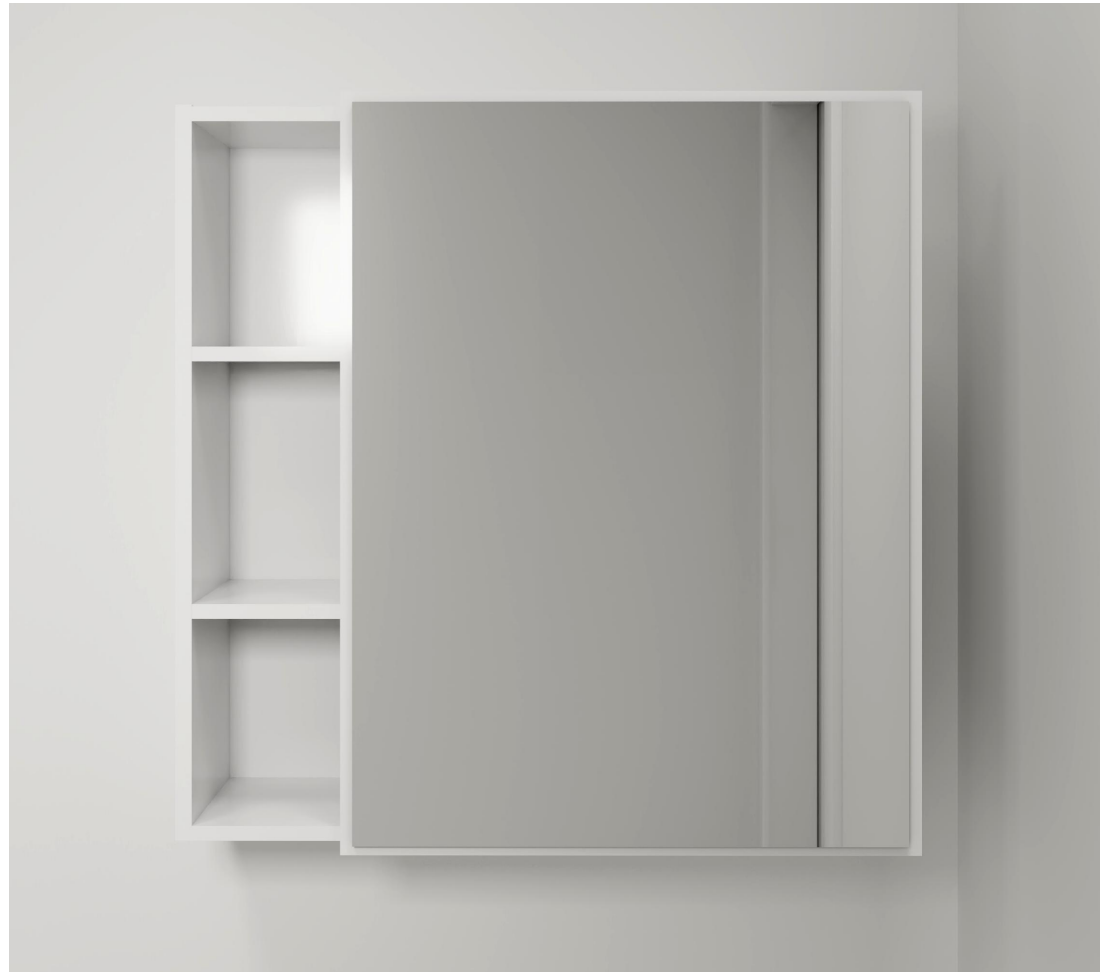

# TYPICAL UNIT PLAN

## TYPE B

- 3 Bedrooms & 2 Bathrooms
- 801 sqft
- 600 units

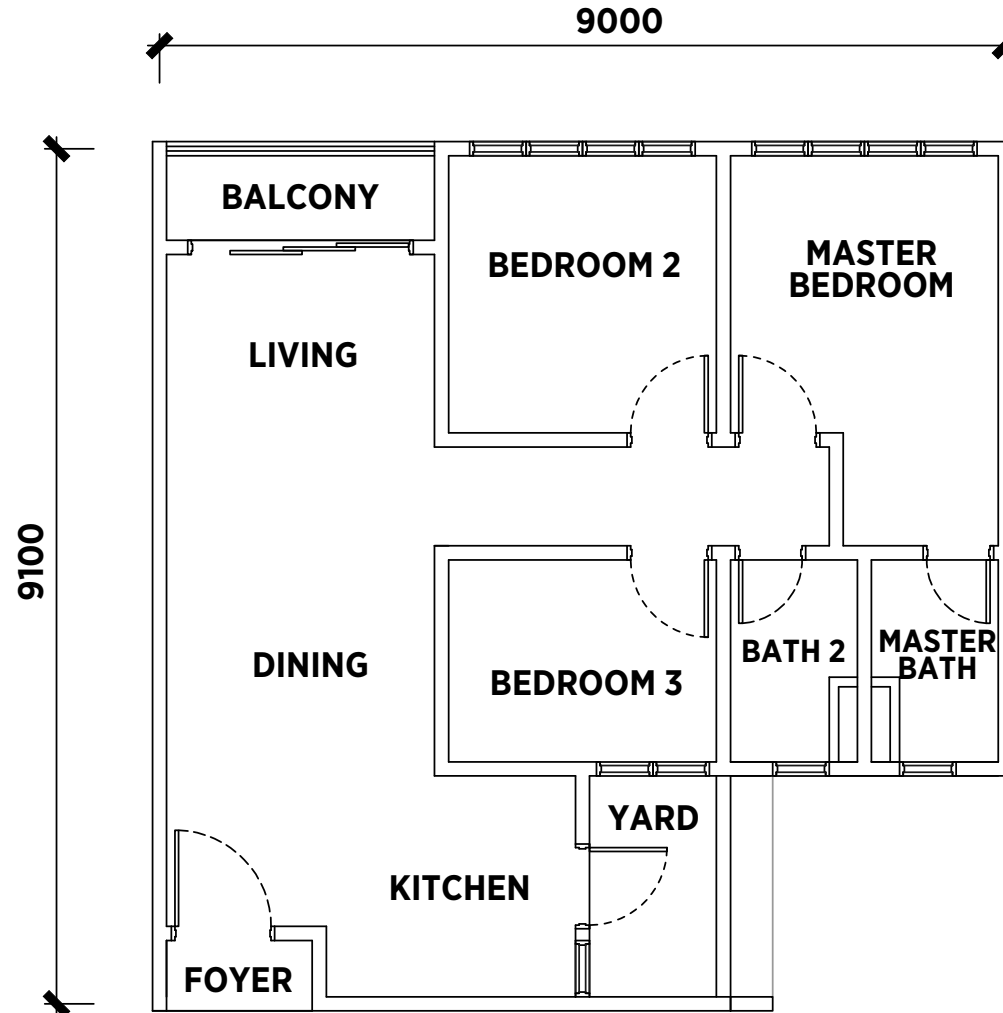

# FURNITURE PACKAGE

## TYPE B

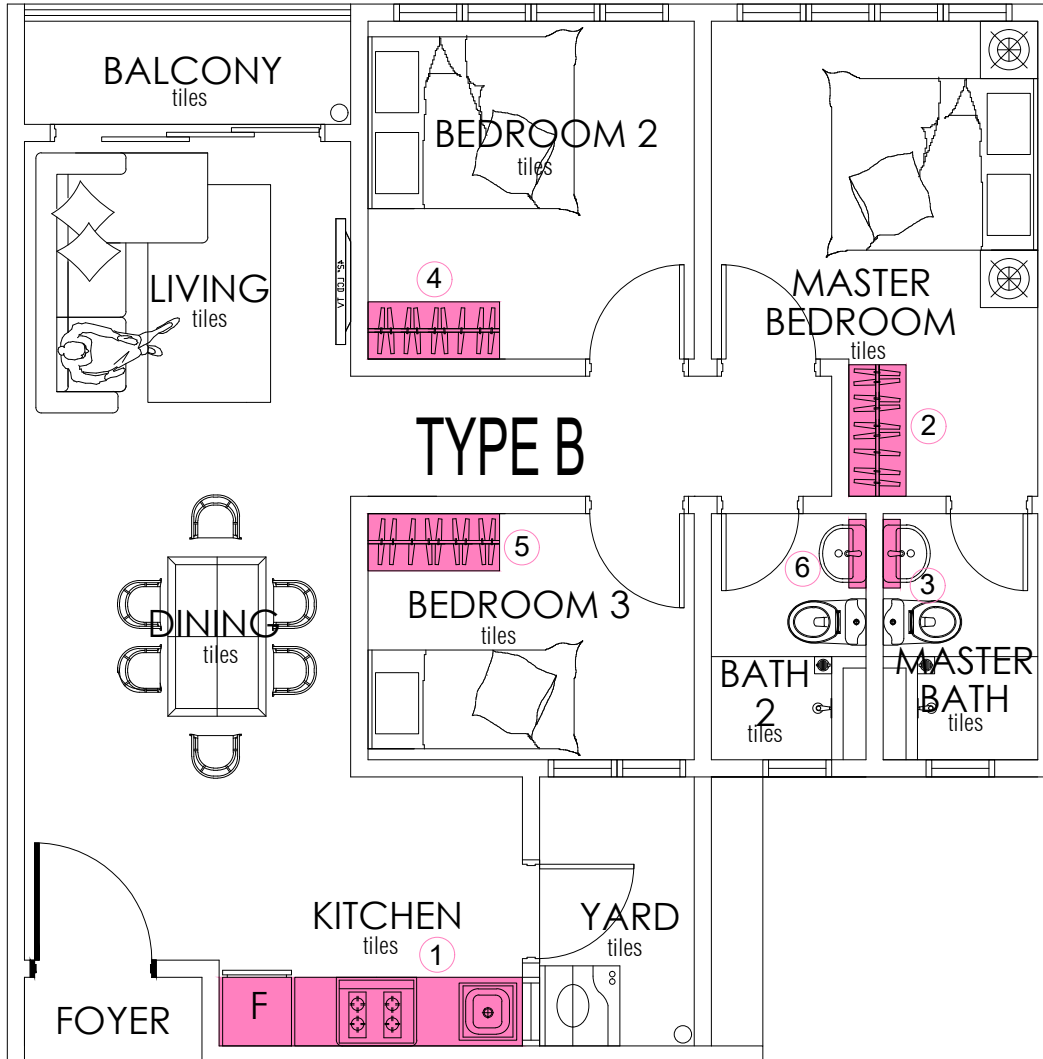

	ITEM	QUANTITY
1.	<u>Kitchen :</u> Kitchen cabinet (hood and hob)	1 Set
2.	<u>Master Bedroom:</u> Wardrobe 1.2 meter length	1 Set
3.	<u>Master Bath:</u> Vanity wall mirror cabinet	1 Set
4.	<u>Bedroom 2:</u> Wardrobe 1.2 meter length	1 Set
5.	<u>Bedroom 3:</u> Wardrobe 1.2 meter length	1 Set
6.	<u>Bath 2:</u> Vanity wall mirror cabinet	1 Set

KITCHEN CABINET  
TYPE : B



BEDROOM 2

TYPE : B



BEDROOM 3

TYPE : B



MASTER BATH

TYPE : B

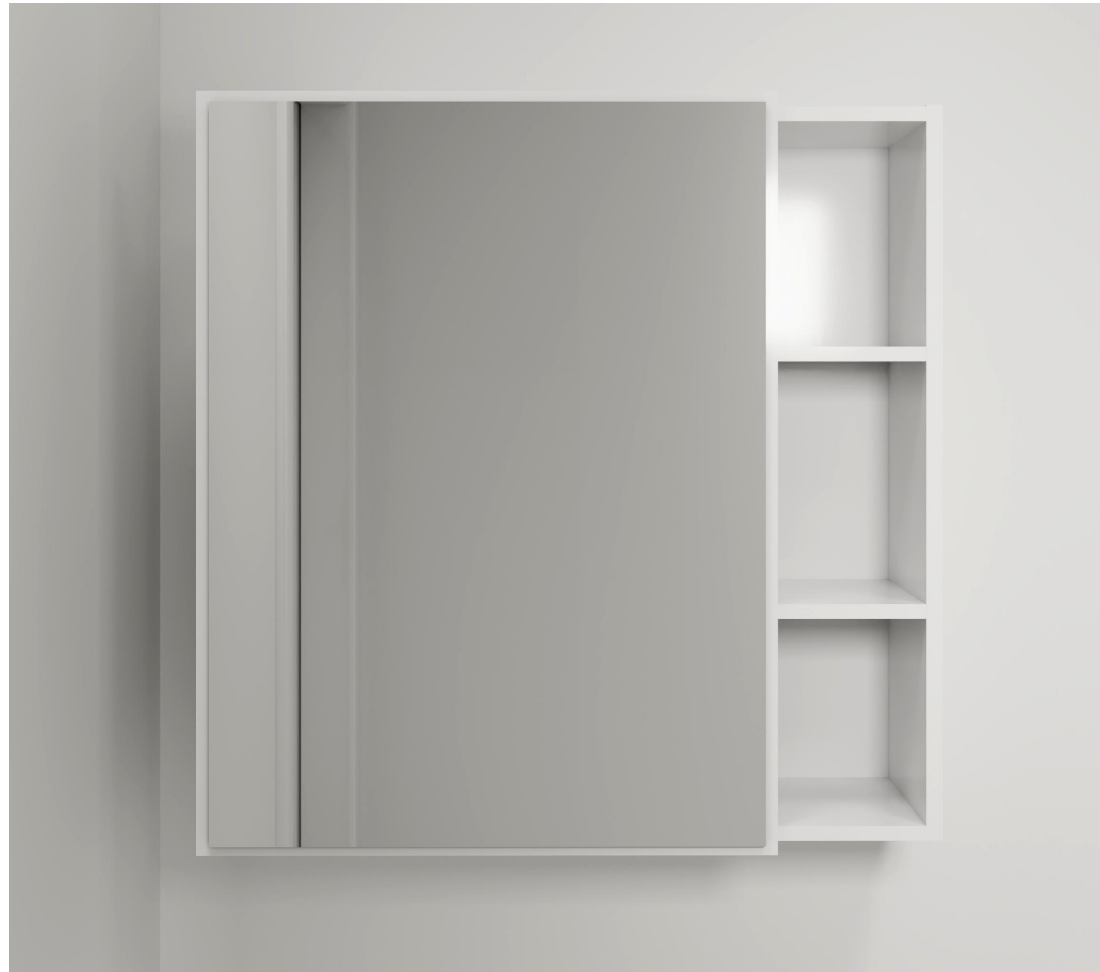

BATH 2  
TYPE : B

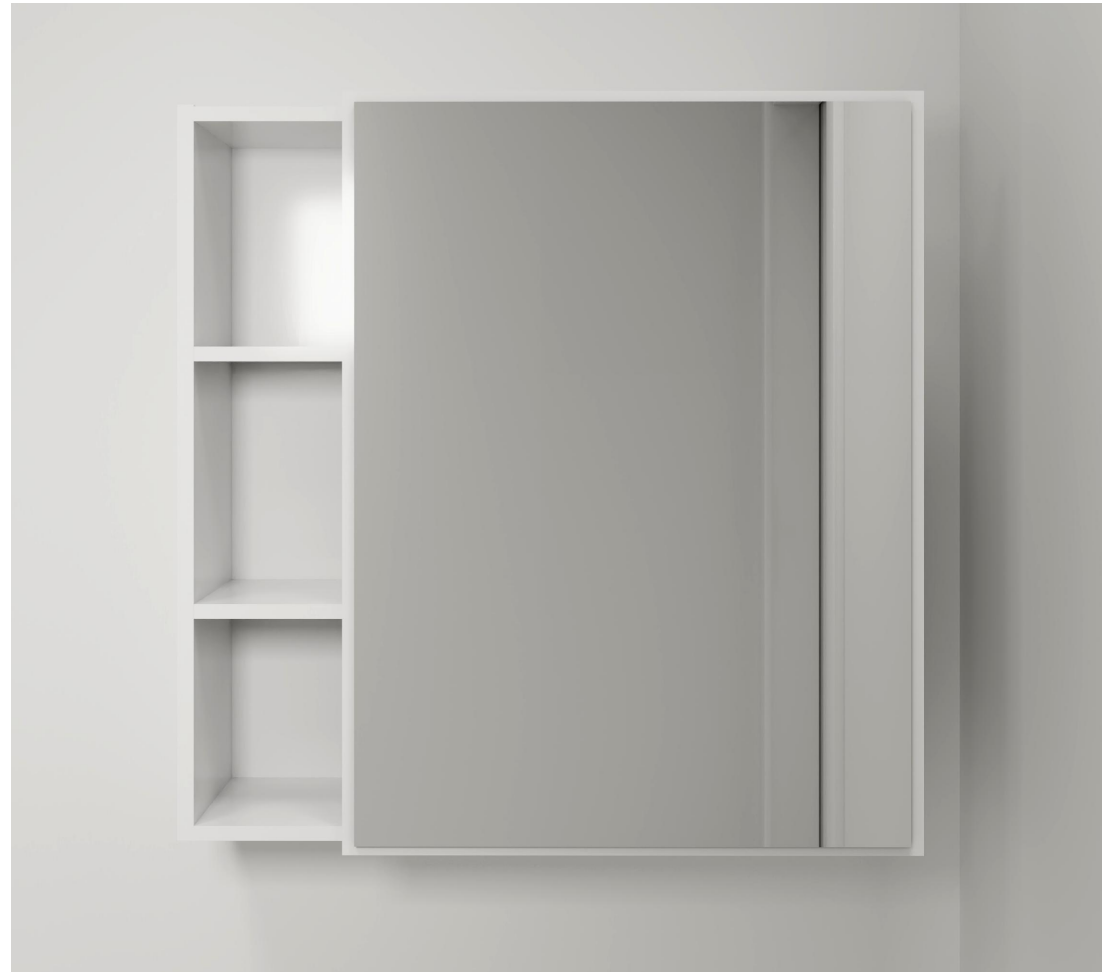

# TYPICAL UNIT PLAN

## TYPE C

- 2 Bedrooms & 2 Bathrooms + Dual Key
- 948 sqft
- 750 units



# FURNITURE PACKAGE

## TYPE C

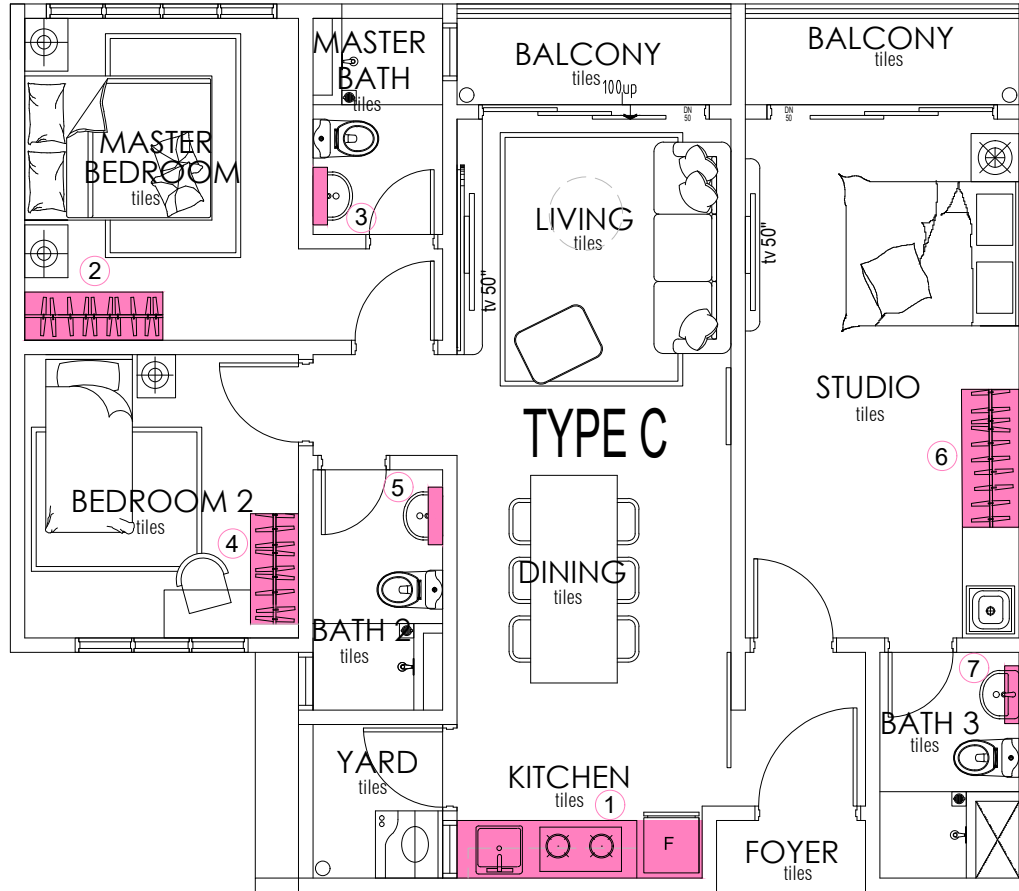

ITEM	QUANTITY
1. <u>Kitchen :</u> Kitchen cabinet (hood and hob)	1 Set
2. <u>Master Bedroom:</u> Wardrobe 1.5 meter length	1 Set
3. <u>Master Bath:</u> Vanity wall mirror cabinet	1 Set
4. <u>Bedroom 2:</u> Wardrobe 1.2 meter length	1 Set
5. <u>Bath 2:</u> Vanity wall mirror cabinet	1 Set
6. <u>Studio:</u> Wardrobe 1.5 meter length	1 Set
7. <u>Bath 3:</u> Vanity wall mirror cabinet	1 Set

KITCHEN CABINET  
TYPE : C



MASTER BEDROOM

TYPE : C



BEDROOM 2  
TYPE : C



STUDIO  
TYPE : C



MASTER BATH & BATH 2 & BATH 3  
TYPE : C

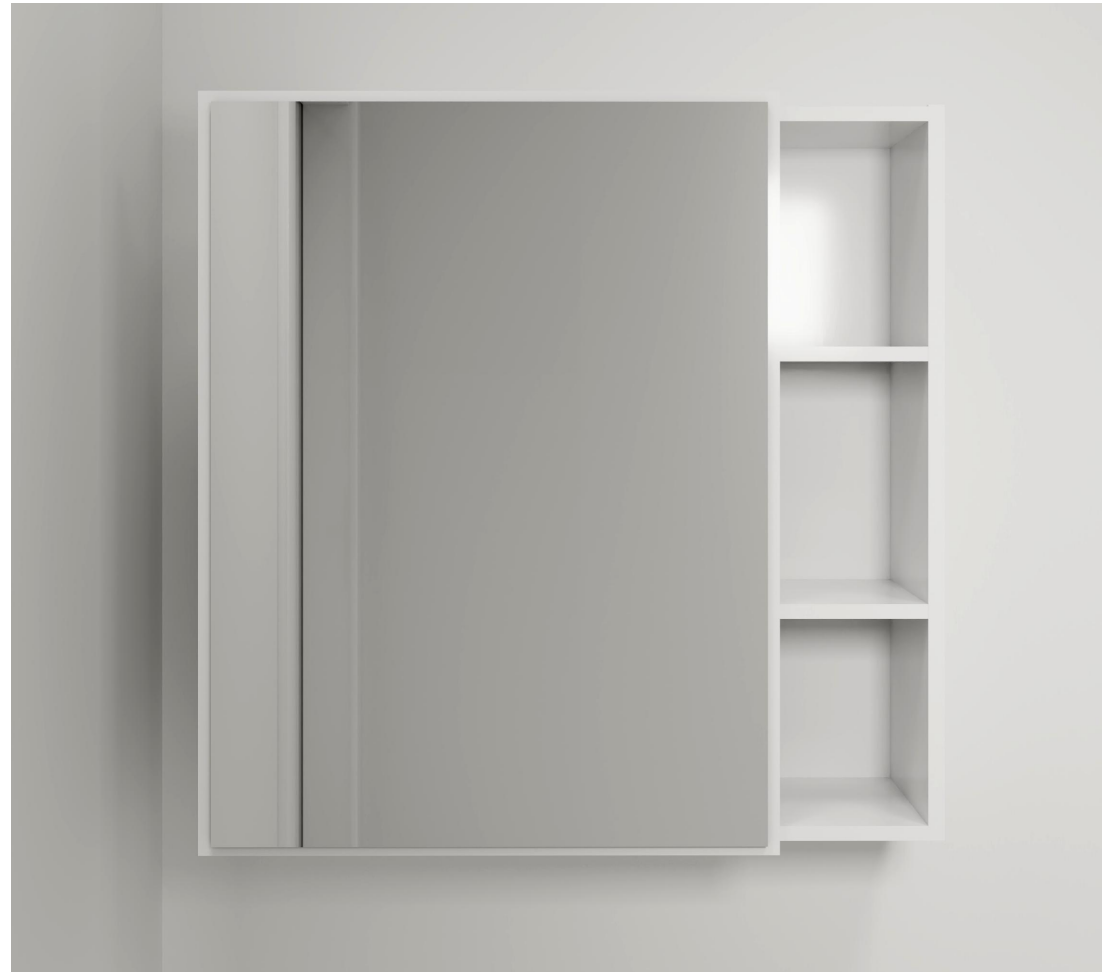





# BUILDING SPECIFICATIONS

## Structure

Reinforced Concrete Frame

## Wall

Concrete Wall / Block Wall / Lightweight Panel Wall

## Roof

Reinforced Concrete Flat Roof

## Ceiling

Skim Coat / Plaster Ceiling

## Windows

Aluminium Framed Glass Windows

## Doors

Main Entrance - Wooden Door

Bedrooms - Wooden Door

Bathrooms - Wooden Door

## Ironmongery

Lock set

## Floor Finishes

Tiles

## Wall Finishes

External Wall - Render / Plaster & Paint

Internal Wall - Skimcoat / Plaster & Paint

Bathrooms - Ceiling Height Tiles

	Type A	Type B	Type C
<b>Sanitary Fittings</b>			
Pedestal Water Closet	2	2	3
Wash Hand Basin	2	2	3
Shower Rose	2	2	3
Kitchen Sink	1	1	1
Bib Tap	3	3	4
<b>Electrical Fittings</b>			
Lighting Point	13	16	20
Fan Point	2	3	3
Power Point (13A/15A)	12	13	17
Water Heater Power Point	2	2	3
Air-Cond Power Point	3	3	4
MATV Point	2	2	2
Distribution Board	1	1	1

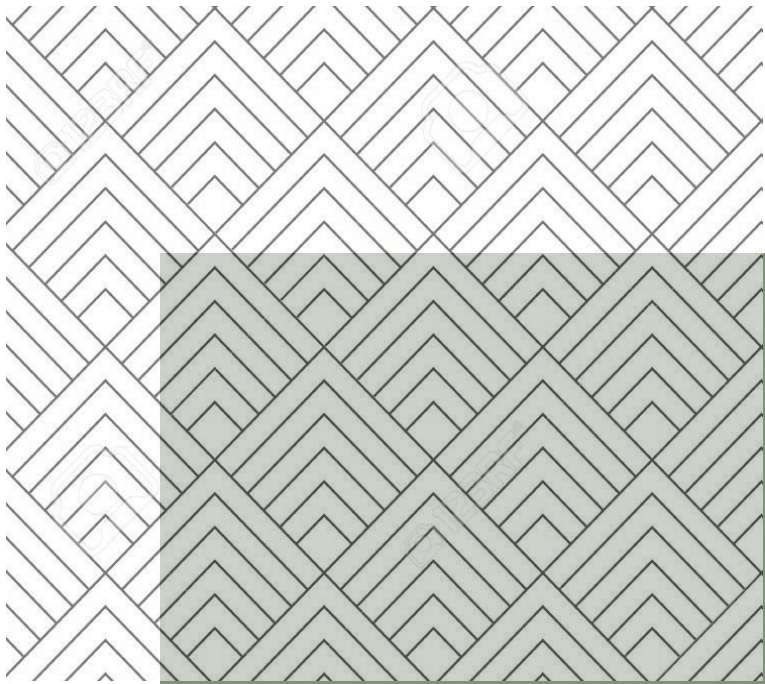

THE  
S  
QUARE

---

# more than just a *mall*.

This nature-inspired property focuses on an active lifestyle, offering open spaces surrounded by greenery, with exciting F&B, education, entertainment, sports activities, and wellness services.



## Social

A vibrant, open space where youth unite to relax and connect in nature.



## Active

A dynamic space for people to embrace an active lifestyle and fuel their passion for movement.



## Green

Nature-covered retail: a green and collaborative society.



## Lifestyle

Where nature meets retail in perfect harmony.



## Food & Beverage

A delicious destination for all, offering diverse F&B options from gourmet dining to trendy fast-casual spots.



## Grocery

A convenient stop for shoppers, offering fresh produce and everyday essentials.



## Education

Education centres that blend academic excellence with vibrant cultural experiences.



## Entertainment

A wide array of entertainment options for a fun-filled experience for all ages.

---

# 5 storey retail mall

Land Area

**11.01 acres**

*Including serviced apartment development site*

Gross Floor Area

*approx.*

**314,373 sq ft**

Net Lettable Area

*approx.*

**173,557 sq ft**

Car Park

*approx.*

**684 nos**

*Including 16 OKU Parking & 2 EV Parking*

---

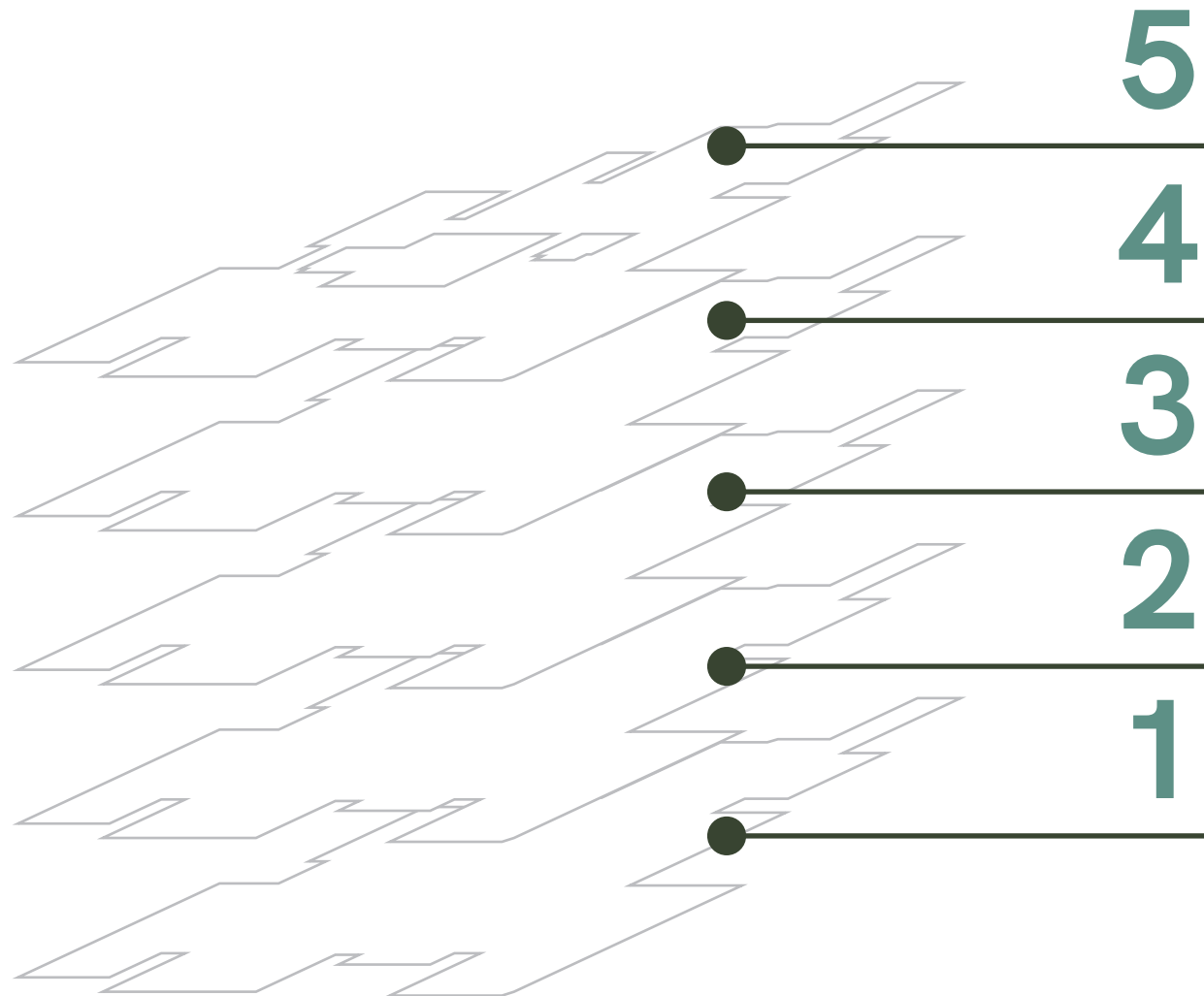

---

*a*

# VIBRANT RETAIL

*in nature*

-  
inspire and cultivate  
the ecosystem and  
culture.

# Delivering an unexpectedly captivating experience for visitors.





**Developer:****Blooming Properties Sdn. Bhd. (202401021031 (1566880-P)**Unit 6.08, Level 6, Plaza DNP, No. 59, Jalan Dato' Abdullah Tahir,  
80300 Johor Bahru, Johor.**T** 07 330 5972 / 330 5979**E** enquiry@mbworld.com.my**W** www.mbworld.com.my

Note: All renderings, illustrations, photographs, furniture, displayed units, landscape amenities or accessories are shown for illustrative purposes only and do not represent the actual design, physical or structural details of the building and/or denote any legal representations. Plans, specifications, materials, unit numbers, address, name of project and other information contained herein are intended to give a general indication of the proposed design only and are subject to change and/or amendments as may be required by the Developer or as directed by the relevant authorities/ architect. All areas and other measurements are approximate only and subject to final survey.

No representation, warranty or undertaking, express or implied, is made as to, and no reliance should be placed on, the fairness, accuracy, completeness or correctness of the information or the opinions contained herein. It is not the intention to provide, and you may not rely on this presentation as providing, a complete or comprehensive analysis of the financial or trading position or prospects of the Developer and related companies. The information and opinions contained in this presentation should be considered in the context of the circumstances prevailing as of the date of this presentation subject to change without notice, and has not been, and will not be, updated or otherwise revised to reflect developments which may occur after the date of this presentation.

None of the Developer, nor any of its related companies, affiliates, directors, officers, employees, advisors or representations shall have the obligation to update on further changes to such information and opinions or to correct any inaccuracies or omissions in this presentation and accuracy of the information and opinions contained in this presentation is not guaranteed. None of the Developer, nor any of its related companies, affiliates or any of their directors, officers, employees, advisors or representatives shall have any liability whatsoever (in negligence or otherwise) for any loss howsoever arising from any use of this presentation or our contents or otherwise arising in connection with the presentation.

This document is solely for reference purpose for your company. You agree not to photograph, copy or otherwise reproduce these materials in any form or pass on, directly or indirectly, these materials, in whole or in part, to any other person (whether within or outside your organization/firm) or publish these materials in any manner for any purpose.